

abbot**Fox**  
Bespoke.





Sabine Cottage, 46 Back Lane, Martham  
*Guide Price £300,000 - £325,000*

“

abbotFox Bespoke is a private office within abbotFox specialising in the sale and letting of some of the region's most exclusive and prestigious properties.

Samuel Le Good | **Head of Bespoke**













## THE DETAIL\_\_\_\_\_

abbotFox Bespoke presents Sabine Cottage, a beautifully reimagined home in the heart of Martham. Tucked away within this sought-after Broadland village, Sabine Cottage has been thoughtfully renovated to blend period charm with modern comfort. Behind its timeless façade, the interiors have been transformed to offer light-filled, elegantly finished living spaces, with every detail curated to create a welcoming and stylish home.

The ground floor flows effortlessly, with versatile reception areas perfect for entertaining or relaxing, while the kitchen pairs contemporary fittings with a nod to the home's heritage. Upstairs, three well-proportioned bedrooms provide generous accommodation, all enhanced by the quality of finish and attention to detail throughout.

Outside, the property continues to impress, offering a private courtyard garden designed for low-maintenance enjoyment, along with the rare advantage of both a garage and off-road parking, whilst the frontage has been thoughtfully planted to offer a typical cottage garden.

Perfectly placed to enjoy village life, Sabine Cottage is an exceptional opportunity to secure a home where character meets convenience. An internal viewing comes highly recommended.











## THE HIGHLIGHTS\_\_

- Stylish, renovated cottage
- Three bedrooms and cloakroom off landing
- Generous living accommodation
- Refitted kitchen and "secret" utility room
- Off road parking and garage (with potential to convert to studio space)
- Convenient location within easy reach of local amenities
- Deceptively spacious
- Cottage gardens
- Internal viewing highly recommended
- Guide Price £300,000 - £325,000



Approx Gross Internal Area  
122 sq m / 1318 sq ft

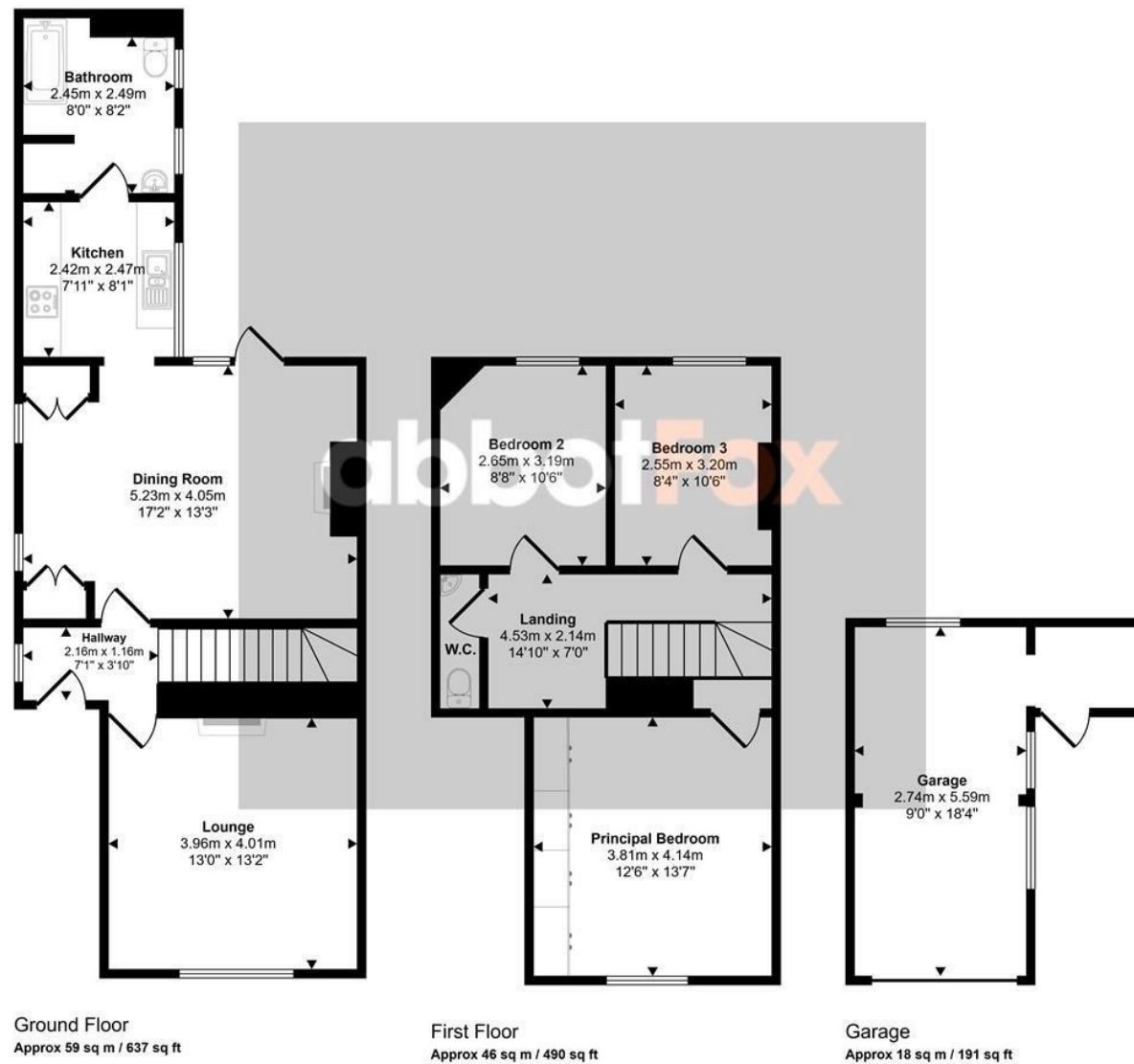

This floorplan is only for illustrative purposes and is not to scale. Measurements of rooms, doors, windows, and any items are approximate.

*Let's talk*

01603 660000

sales@abbotfox.co.uk

@abbotfox @abbotfoxbespoke

EPC RATING -

Disclaimer – In accordance with the Property Misdescriptions Act, the company abbotFox gives notice that all descriptions, references to condition, necessary permissions for use and other details are given in good faith and believed to be correct, but any purchaser should not rely on them as statements of fact, and must satisfy themselves by inspection or other means, as to their accuracy.